

Smart POS

User Guide

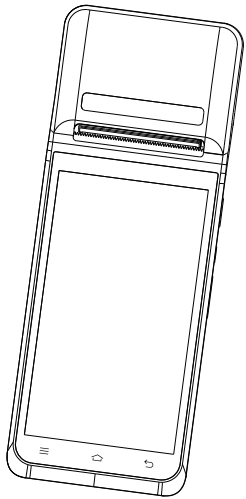

Packing list

After opening the box, check the components, if it's lack of any one or product description appears missing pages and other serious impact on reading, please contact the seller.

Item	Model/Spec	Quantity
Smart Pos	/	1pcs
Printer paper	58*40(<=40mm)	1pcs
Charger	5V/2A	1pcs
Usb charging cable	Type-C	1pcs
User Guide	/	1pcs
Battery	7.6V 3200mAh	1pcs

Instructions of appearance

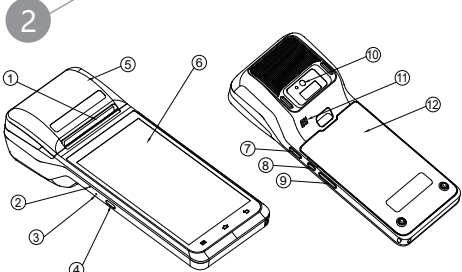

- 1.Print Outlet
2.Recording Hole
3.Reset Hole
4.Type-C Interface
5.Contactless card reaction area
6.Display
- 7.One Key Scanning
8.Power Button
9.Volume + OR -
10.Camera
11.Loudspeaker
12.Battery Location

Quick entry

1. 5-8 hours Full time charging, when you use it at the first time.
2. Pull out the rear cover to put the sim cards into it, then power on device.
3. Finish the account setting as the system guiding, you also can skip it.
4. Find the setting to connect to WIFI.
5. Find the preinstalled application "Pos Test"
6. Finish testing the device to ensure no quality problem.
7. If everything is fine, you can download your application to use it.

User manual

1. ON/OFF Device
Power ON: Long press the power button for 2-3 seconds to turn on it when it is off.
Power OFF: Long press the power button for 2-3 seconds to select power off or Restart, Airplane Mode when it is on.
Lock screen: Short press when it is on.

2. Contactless Card Reading

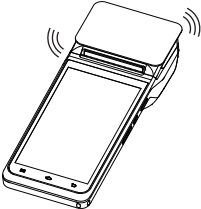

Open your application, Put your RFID or IC cards on the RFID/NFC contactless card reading area.

3. Setting thermal roll paper or label

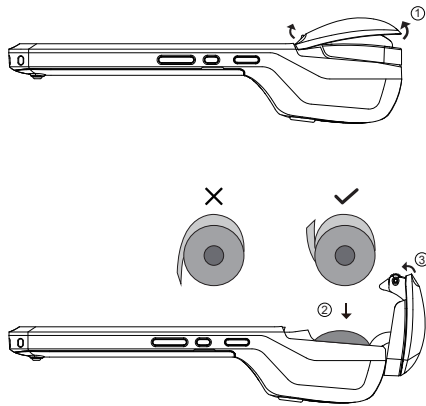

This device support to loading 58mm thermal receipt or label paper roll.

4. Printer
Open your application and connect it with"Printer" or "Printer Service", then You can print it through your application setting. If you can not connect the printer, please contact the seller.

5. Battery Charging
Connect the AC plug with Type-c cable, it will cost you 6 hours to finish charging.
Please turn off the device if it is on a long standby time.
Please keep charging device at least one time every 3 months.

6. Charging Status Description
Charging: the screen will light up, it will show charging on the right top corner of the screen.
Finish Charging: the screen will lock, it will stop charging.

7. We built in a RS232 Mini USB interface for firmware upgrading.

Notes of using lithium battery

1. Do not damage the USB cable and battery, please disuse if any breakage.
2. Please use the original matched adaptor, we are not sure the danger from the other high voltage adaptor.
3. Prohibited exposure, rain, high concentrations of the product in a dusty, high temperature, humidity environment.
4. Please keep device away from liquid, and use the alcohol to clean it.
5. Do not block any interface or hole, it is dangerous behave leads to destroying the device.
6. Do not repair it privately, please ask the help from the pos repairing center or contact seller.
7. Please do not dismantle the device privately, prohibit opening the device when it is on.
8. Do not use the device or external interface in a dangerous environment.
9. A cotton swab dipped in alcohol is the best cleaning tool.

Warranty card

Machine name	
User name	
Recipient	
Address	
Mobile	
Serial number (SN)	
Buy date	

Service record after selling			
Date	Service record	Service man	Signature of user

- Attention
1. The warranty period: since the date of purchase free warranty for 12 months.
 2. Due to natural disasters, fires, self-modification or misuse of the situation caused by the failure, not within the free warranty range.
 3. Free warranty service is limited to the original configuration of the parts.
 4. No sales unit seal or the initial warranty card, will not provide warranty service.

单页尺寸: 68*120mm
材质: 128g铜版纸

FCC Statement

This equipment has been tested and found to comply with the limits for a Class B digital device, pursuant to part 15 of the FCC Rules. These limits are designed to provide reasonable protection against harmful interference in a residential installation. This equipment generates, uses and can radiate radio frequency energy and, if not installed and used in accordance with the instructions, may cause harmful interference to radio communications. However, there is no guarantee that interference will not occur in a particular installation. If this equipment does cause harm full interference to radio or television reception, which can be determined by turning the equipment off and on, the user is encouraged to try to correct the interference by one or more of the following measures:

- Reorient or relocate the receiving antenna.
- Increase the separation between the equipment and receiver.
- Connect the equipment into an outlet on a circuit different from that to which the receiver is connected.
- Consult the dealer or an experienced radio/TV technician for help.

Caution: Any changes or modifications to this device not explicitly approved by manufacturer could void your authority to operate this equipment.

This device complies with part 15 of the FCC Rules. Operation is subject to the following two conditions:

(1) This device may not cause harmful interference, and (2) this device must accept any interference received, including interference that may cause undesired operation.

Specific Absorption Rate (SAR) information:

This Device meets the government's requirements for exposure to radio waves. The guidelines are based on standards that were developed by independent scientific organizations through periodic and thorough evaluation of scientific studies. The standards include a substantial safety margin designed to assure the safety of all persons regardless of age or health. FCC RF Exposure Information and Statement the SAR limit of USA (FCC) is 1.6 W/kg averaged over one gram of tissue. Device types: Device has also been tested against this SAR limit. This device was tested for typical body-worn operations with the back of the device kept 0mm from the body. To maintain compliance with FCC RF exposure requirements, use accessories that maintain an 0mm separation distance between the user's body and the back of the device. The use of belt clips, holsters and similar accessories should not contain metallic components in its assembly. The use of accessories that do not satisfy these requirements may not comply with FCC RF exposure requirements, and should be avoided.