

# Motorized SmartDrape User's Manual

Model: MSD-B

## Safety Statement

FCC Compliance Statement: This device complies with Part 15 of the FCC rules. Operation is subjected to the following two conditions: (1) this device may not cause harmful interference, and (2) this device must accept any interference received, including interference that may cause undesired operation.

This equipment has been tested and found to comply with the limits for a Class B digital device, pursuant to Part 15 of the FCC Rules. These limits are designed to provide reasonable protection against harmful interference in a residential installation. This equipment generates, uses and can radiate radio frequency energy and, if not installed and used in accordance with the instructions, may cause harmful interference to radio communications. However, there is no guarantee that interference will not occur in a particular installation. If this equipment does cause harmful interference to radio or television reception, which can be determined by turning the equipment off and on, the user is encouraged to try to correct the interference by one or more of the following measures:

- Reorient or relocate the receiving antenna.
- Increase the separation between the equipment and receiver.
- Connect the equipment into an outlet on a circuit different from that to which the receiver is connected.
- Consult the dealer or an experienced radio/TV technician for help.

FCC Caution: Any changes or modifications not expressly approved by the party responsible for compliance could void the user's authority to operate this equipment. This transmitter must not be co-located or operating in conjunction with any other antenna or transmitter.

This device contains licence-exempt transmitter(s)/receiver(s) that comply with Innovation, Science and Economic Development (ISED) Canada's licence-exempt RSS(s). Operation is subject to the following two conditions: (1) this device may not cause interference, and (2) this device must accept any interference, including interference that may cause undesired operation of the device. The device has been evaluated to meet general RF exposure requirement. The distance between user and products should be no less than 20cm.

Cet appareil contient des émetteurs/récepteurs exemptés de licence qui sont conformes aux flux RSS exempts de licence du Canada pour l'innovation, la Science et le développement économique (ISDE). Le fonctionnement est soumis aux deux conditions suivantes: (1) ce dispositif ne peut pas causer d'interférence, et (2) ce dispositif doit accepter toute interférence, y compris les interférences pouvant causer un fonctionnement indésirable du dispositif. L'appareil a été évalué pour répondre aux exigences générales d'exposition aux RF.

la distance entre l'utilisateur et les produits devraient être au moins 20 cm

# Safety Precautions

Thank you for your purchase. Please review the instructions carefully before using the product, and save these instructions for future consultation.

- **WARNING!** Important safety instruction: It is critical for your safety and the safety of those around you to follow these instructions. Save these instructions.
- **WARNING!** The drive shall be disconnected from its power source during cleaning, maintenance and when replacing parts.
- The products may contain Lithium-ion batteries; the battery contains flammable materials such as organic solvents. Please read the Important Safety Precautions before using the product.
- Please recharge the batteries every 3-6 months to ensure optimal performance of batteries.
- Product operation is intended for temperatures between 0°C/32°F ~40°C/104°F.
- Please note that the limited warranty will be voided if the product is modified, dismantled or used in any manner other than its intended purpose.
- The accessories, including Remote, Hub, and Repeater are designed to be used with our Motorized Shades. Do NOT use them for any other purpose.
- Please make sure the shade route is clear when operating to avoid danger or damage.
- In order to improve the user experience and functionality, the firmware and software of this product will automatically update from time to time. (When the Hub is installed)
- Do NOT disassemble the products or any of their components. They do not contain serviceable parts. Servicing of these products should be referred to qualified personnel.
- This appliance contains batteries that are only replaceable by skilled personnel, trained Norman retailer or electrician.
- Do NOT operate the product with wet hands to avoid risk of electrical shock. The product needs to be powered off and disconnected from its power source during cleaning, maintenance and/or replacing parts.
- Do NOT operate the shade or swing the Power Charger while charging.
- The appliance is not intended for use by persons (including children) with reduced physical, sensory or mental capabilities, or lack of experience and knowledge, unless they have been given supervision or instruction concerning use of the appliance by a person responsible for their safety. Children should be supervised to ensure that they do not play with the appliance. (not for EU/UK market)
- This appliance can be used by children aged from 8 years and above and persons with reduced physical, sensory or mental capabilities or lack of experience and knowledge if they have been given supervision or instruction concerning use of the appliance in a safe way and understand the hazards involved. Children shall not play with the appliance. Cleaning and user maintenance shall not be made by children without supervision. (for EU/UK market only)
- **WARNING:** Important safety instructions. It is important for the safety of persons to follow these instructions. Save these instructions.
- **WARNING:** Important safety instructions. Follow all instructions, since incorrect installation can lead to severe injury
  - before installing the drive, remove any unnecessary cords or components and disable any equipment not needed for powered operation;
  - the characteristics of the driven part must be compatible with the rated load and rated operating time;
  - the mass and the dimension of the driven part shall be compatible with the rated torque and rated operating time;
  - fixed controls have to be clearly visible after installation;
- This appliance contains batteries that are only replaceable by skilled persons.
- Do NOT operate when maintenance, such as window cleaning, is being carried out in the vicinity.

## Specification

No.	Item	Specification
1.	Power Source	Li-ion Battery Pack (4S1P)
2.	Radio type	2.4G RF
3.	Motor type	Brush DC motor
4.	Charge type	USB Type C charger
5.	Charging Time	6~9 Hours
6.	Charging Temperature	5°C/41°F ~ 35°C/95°
7.	IP Ranking	IP20
8.	Operating Temperature	-20°C/-4°F ~ 65°C/149°F
9.	Relative Humidity	0% ~ 90% (Non-condensing)
10.	Ave. Sound Level @1m	≤ 40 dB

## Shade & Accessories

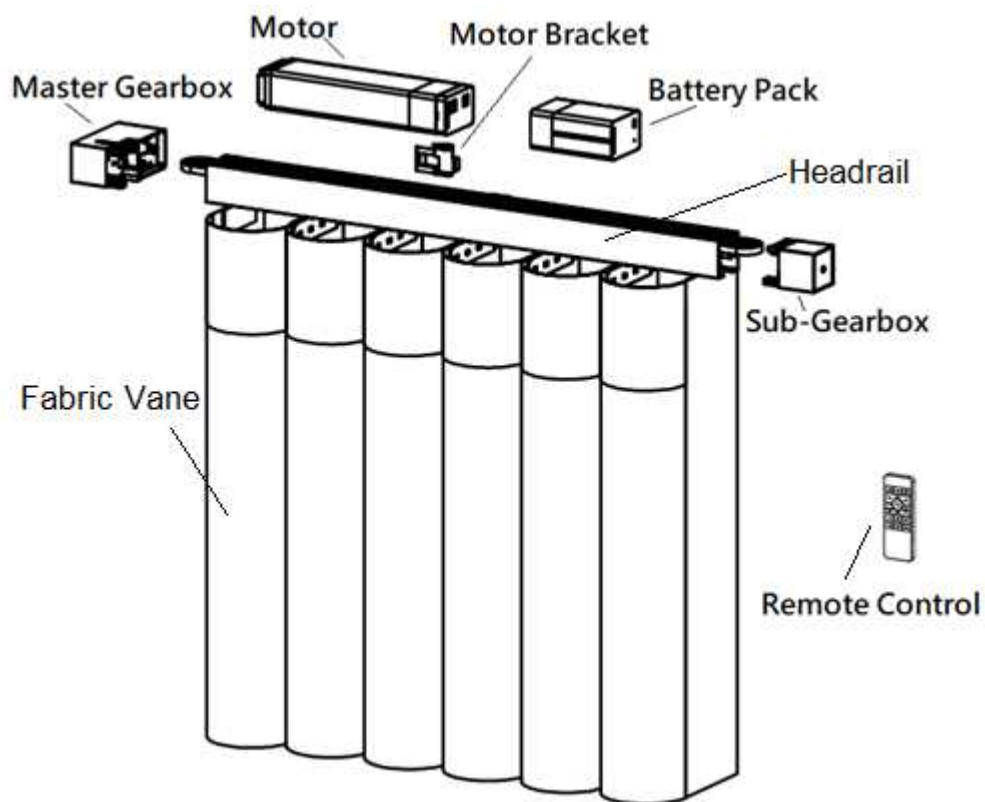

# Setup & Operation

## Power on/ Power off

Automatically power on when the motor connects to the power :

Blue light flashes 4 times, and buzzer sounds twice.

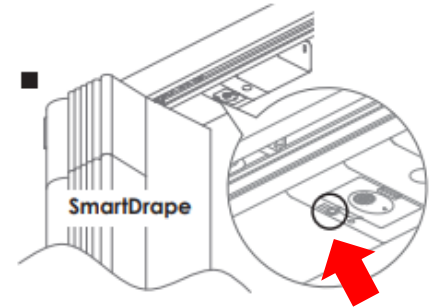

**Power on:** Press the button for 3 seconds. Blue light flashes 4 times, and buzzer sounds twice.

**Power off:** Press the button for 3 seconds. Red light flashes 4 times.

## Remote Pairing

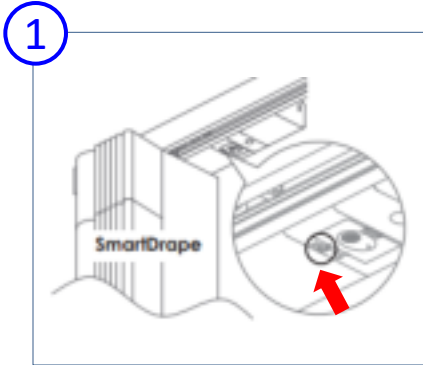

1 Make sure the motor is powered on. Press the button 3 times fast to start the pairing mode. Blue light flashes for 1 min.

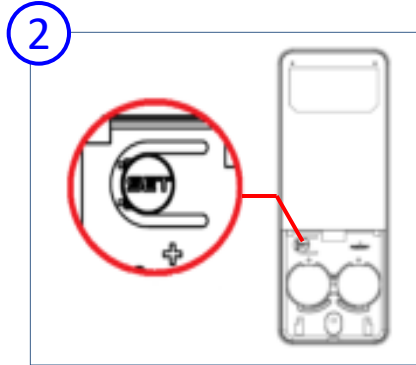

2 Press the SET button on the remote. All group numbers on the remote light on and flash slowly.

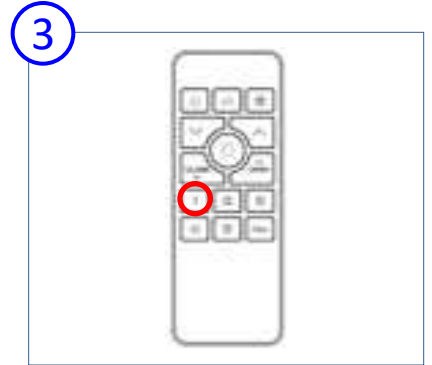

3 Select the group to be paired. The selected group number flash.

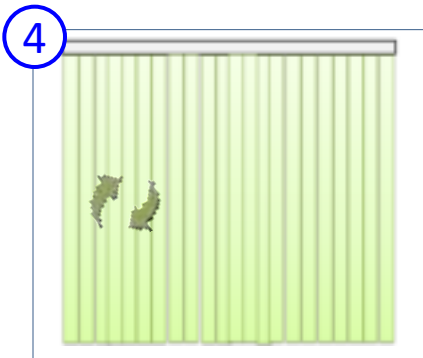

4 The fabric vanes rotate if the pairing is done. The light on the motor goes out.

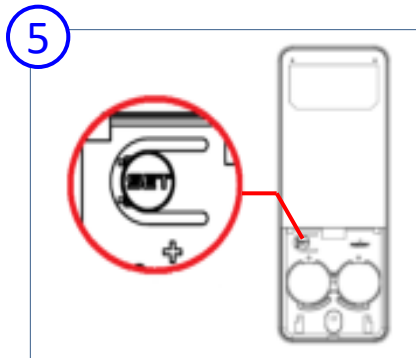

5 Press the SET button on the remote for 3 seconds to leave the SET mode. Remote light out.

# Setup & Operation

## Remote Unpairing

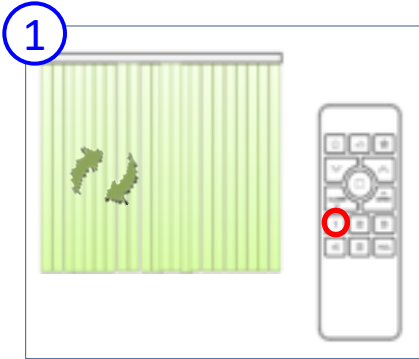

1 Press the group button on the remote and the paired shade(s) shake.

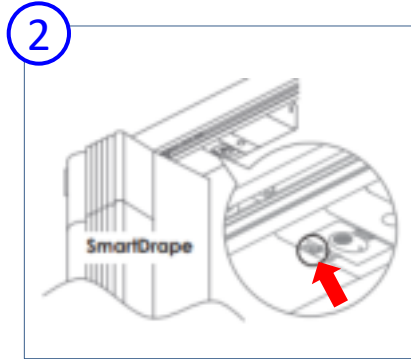

2 Press the button 3 times fast to the pairing mode. Blue light flashes for 1 min.

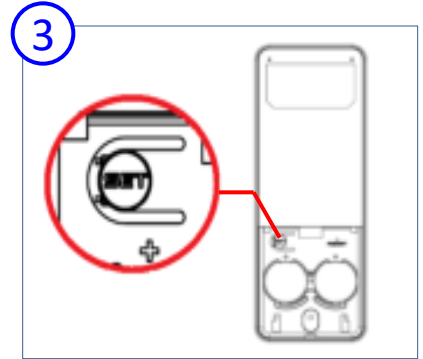

3 Press the SET button on the remote. All group numbers on the remote light on and flash slowly.

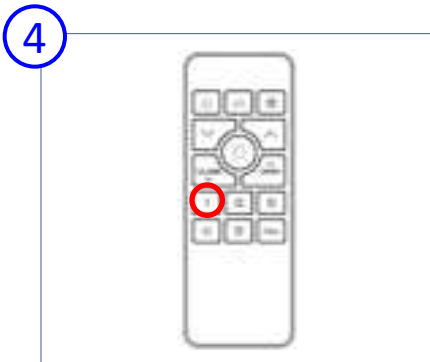

4 Select the group to be unpaired. The selected group number flash.



5 The fabric vanes rotate twice if the unpairing is done. The light goes out.

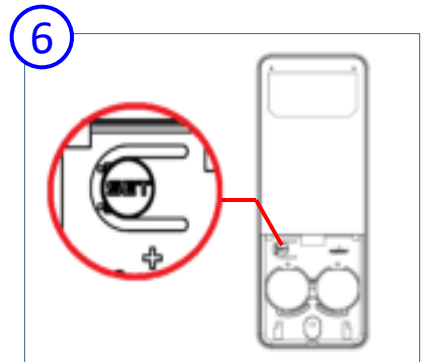

6 Press the SET button on the remote for 3 seconds to leave the SET mode. Remote light out.

# Setup & Operation

Note: To avoid affecting other shade setting, please turn off the motor for other shades when you are doing shade setting.

Important: The limits must be completely set to operate the full function normally.

## Set Fully Opened Limit

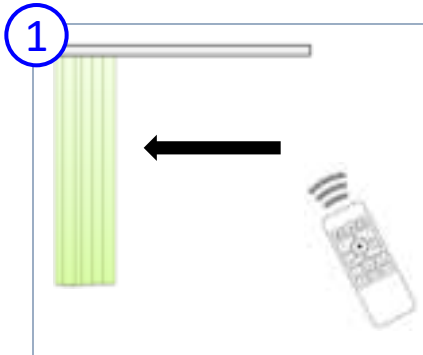

Stack all fabric vanes aside to the fully-opened position.

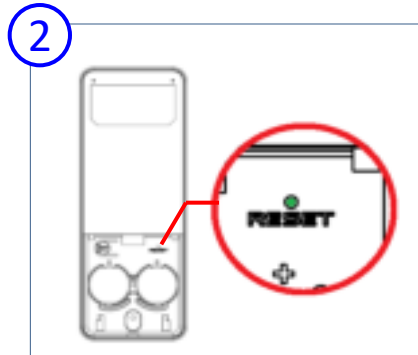

Long press RESET button on the remote. All group numbers on the remote light on and flash fast.

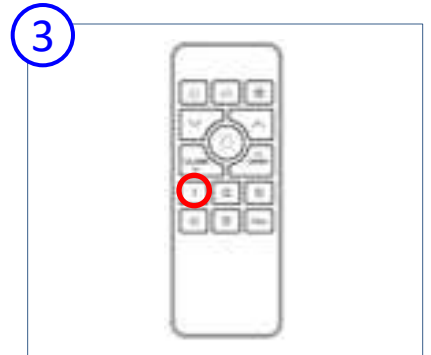

Select the group number to be set up. The selected group number flash.

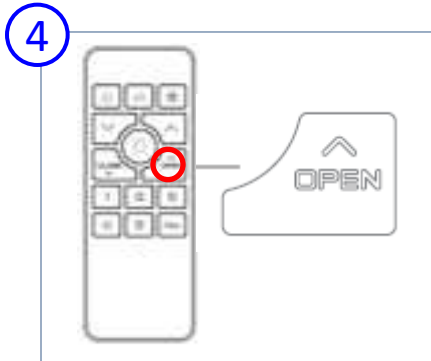

Short press the OPEN button on the remote to set the fully- opened limit.

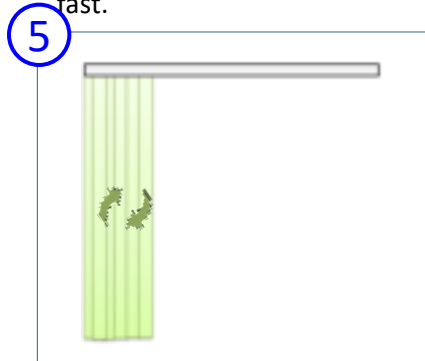

The shade shakes once and the fully- opened limit is successfully set.

## Clear Fully Opened Limit

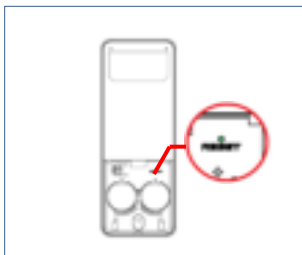

Long press RESET button on the remote. All group numbers on the remote light on and flash fast.



Select the group number to be set up. The selected group number flash.

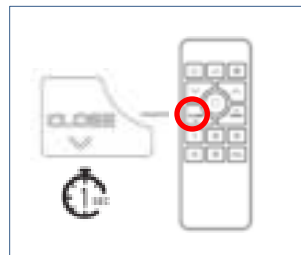

Press OPEN button until all group numbers flash fast to clear the fully opened limit.

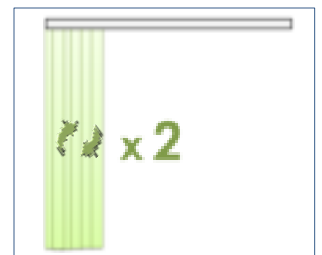

The shade shakes twice. The clear is done.



# Setup & Operation

Note: To avoid affecting other shade setting, please turn off the motor for other shades when you are doing shade setting.

Important: The limits must be completely set to operate the full function normally.

## Set Fully Closed Limit

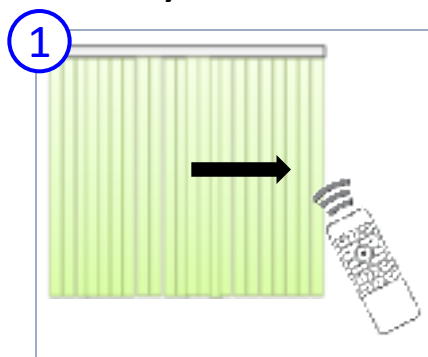

Expand all fabric vanes and rotate the vanes to fully-closed position (privacy).



Long press RESET button on the remote. All group numbers on the remote light on and flash fast.



Select the group number to be set up. The selected group number flash.

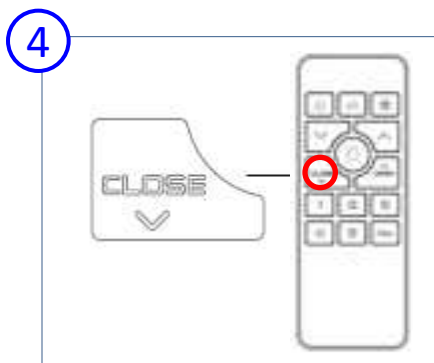

Short press the CLOSE button on the remote to set the fully-closed limit.

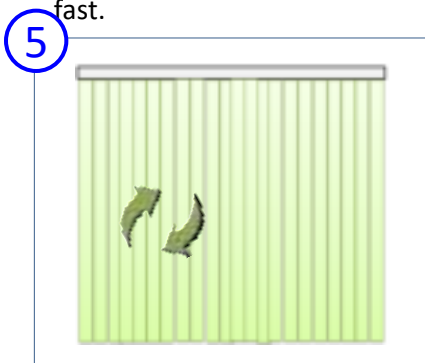

The shade shakes once and the fully-closed limit is successfully set.

## Clear Fully Closed Limit

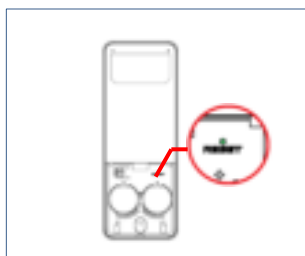

Long press RESET button on the remote. All group numbers on the remote light on and flash fast.



Select the group number to be set up. The selected group number flash.

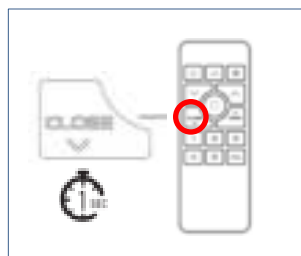

Press CLOSE button until all group numbers flash fast to clear the fully-closed limit setting.



The shade shakes twice. The clear is done.

# Setup & Operation

Note: To avoid affecting other shade setting, please turn off the motor for other shades when you are doing shade setting.

Important: The limits must be completely set to operate the full function normally.

## Set Special Limit (Vane to 90 Degree)

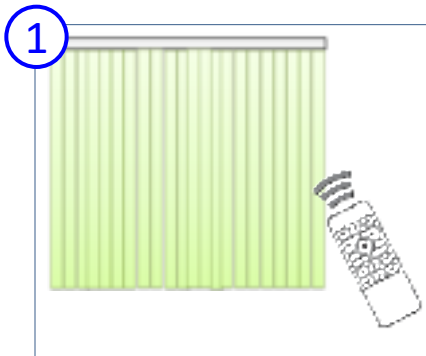

Expand all fabric vanes and keep the vanes U shapes (90 degree)

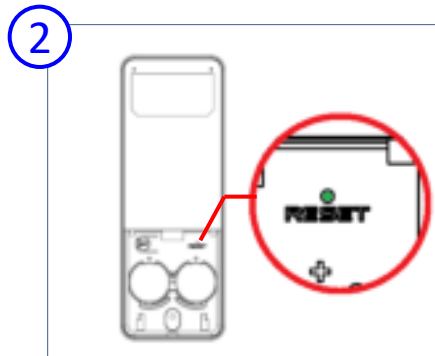

Long press RESET button on the remote. All group numbers on the remote light on and flash fast.

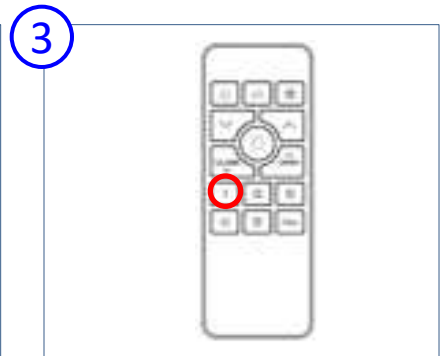

Select the group number to be set up. The selected group number flash.

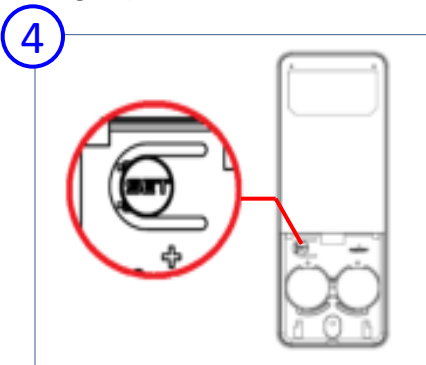

Short press the RESET button on the remote to set the special limit.



The shade shakes once and the special limit is successfully set.

## Clear Special Limit

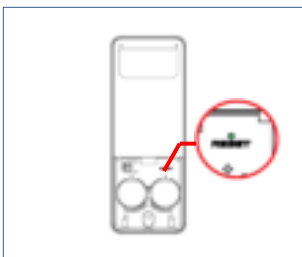

Long press RESET button on the remote. All group numbers on the remote light on and flash fast.



Select the group number to be set up. The selected group number flash.

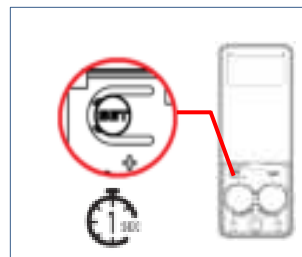

Press SET button until all group numbers flash fast to clear the special limit setting.



The shade shakes twice. The clear is done.

## Setup & Operation

Note: The fully opened/ fully-closed/ special limits must be completely set before setting my favorite. My favorite setting won't work if any of the fully-opened/ fully-closed/special limits is cleared.

### Set My Favorite

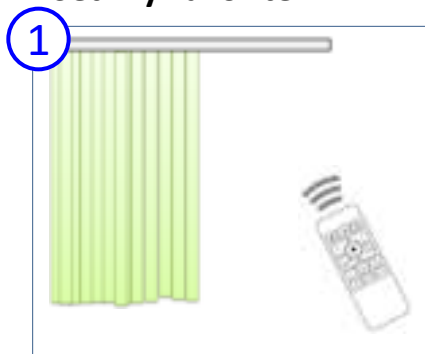

Use the remote and move the vanes to the preferred position & angle.

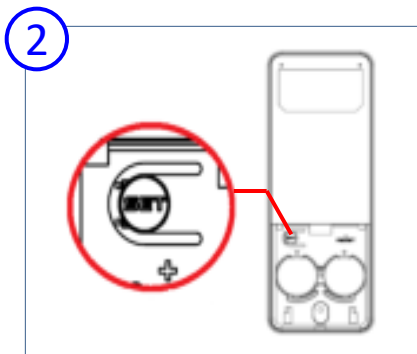

Long press SET button on the remote. All group numbers on the remote light on and flash slowly.

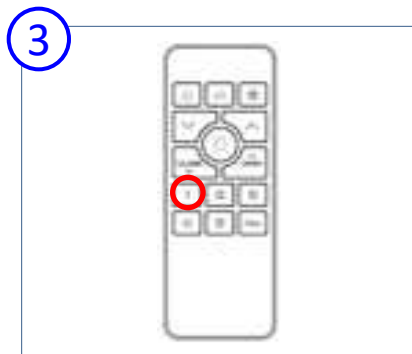

Select the group number to be set up. The selected group number flash.

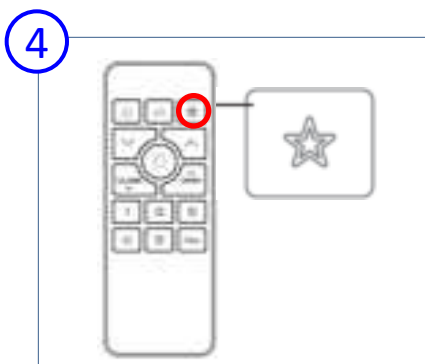

Short press the "star icon" button to set my favorite.

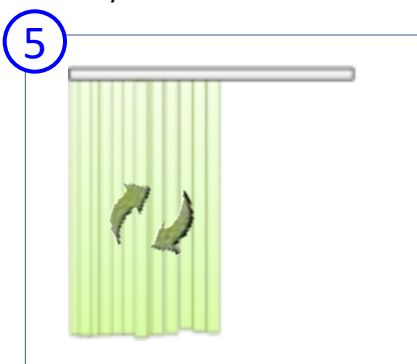

The shade shakes once and my favorite is successfully set.

### Clear My Favorite

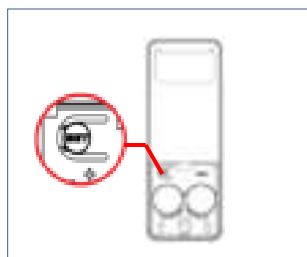

Long press SET button on the remote. All group numbers on the remote light on and flash slowly.



Select the group number to be set up. The selected group numbers flash.

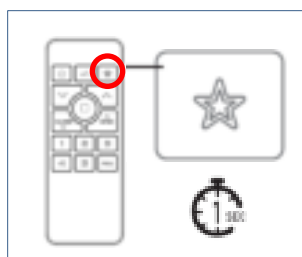

Press the button with star icon until all group numbers flash fast to clear my favorite setting.

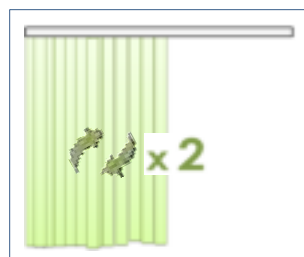

The shade shakes twice. The unset is done.

## Remote Button Function



^ / v : Rotate fabric vanes toward right/left

OPEN : Stack fabric vanes

CLOSE : Extend fabric vanes and keep the vanes at 90 degree

■ : Stop the shade

▲ : Move to Best View

🏠 : Move to Best Privacy

★ : Move to My Favorite

Press Group(1-5, ALL) : Select a group

Hold Group(1-5, ALL) : Identify the shades in the group